

# EKSOLHWAV1+EKHWSU

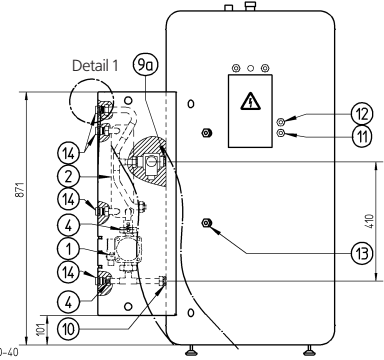
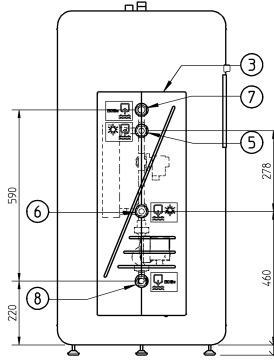
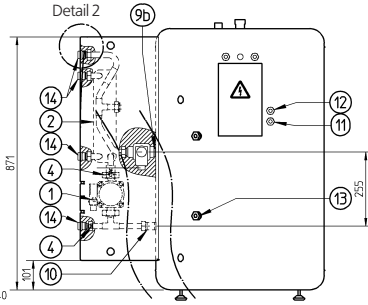
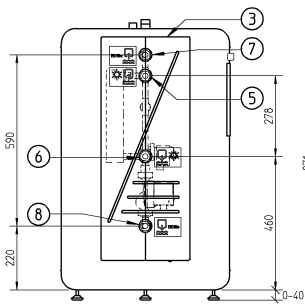
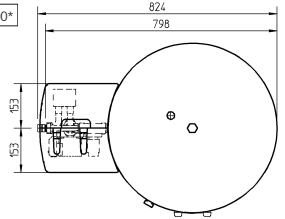
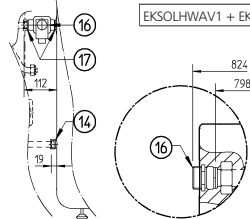
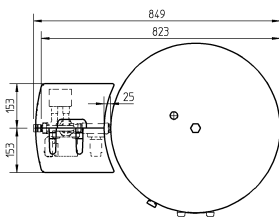
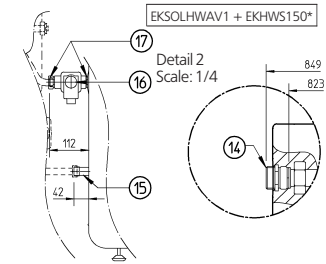

## Switchbox domestic hot water tank

- ① Cable entry (Altherma indoor unit)
- ② Cable entry (Pump cable)

## Minimum space for service & ventilation

## Accessories (delivered with EKSOLHWAV1)

- ⑬ Thermistor socket (thermistor solar pump station) (internal diameter 6.1mm)
- ⑭ Adapter 3/4" M BSP-3/4" M BSP
- ⑮ Adapter (Field supply) 3/4" F BSP-3/4" M BSP

## Connection type

- ⑯ Solenoid valve 3/4" F BSP-3/4" F BSP
- ⑰ Adapter 3/4" M BSP-3/4" M BSP Solenoid valve

## EKJHWA Kit

- ⑱ Solenoid valve 3/4" F BSP-3/4" F BSP
- ⑲ Adapter 3/4" M BSP-3/4" M BSP Solenoid valve

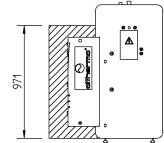
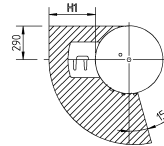

Model	H1
EKHWSU150*	430
EKHWSU200*	400
EKHWSU300*	400

Service space  
Scale: 1/20

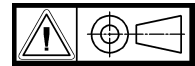

## Components

- ① Pump + switch for speed setting
- ② Heat exchanger
- ③ EPP casing
- ④ Non return valves

## CONNECTIONS

- ⑤ Inlet connection from solar pump station 3/4" F BSP
- ⑥ Return connection to solar pump station 3/4" F BSP
- ⑦ Inlet connection from Altherma indoor unit 3/4" F BSP
- ⑧ Return connection to Altherma indoor unit 3/4" F BSP
- ⑨ EKSOLHWAV1 return connection to the domestic hot water tank heatexchanger 3/4" F BSP
  - ⊕ 200-300l Tank
  - ⊕ 150l Tank
- ⑩ EKSOLHWAV1 inlet connection from the domestic hot water tank heatexchanger 3/4" F BSP