

EWA/YQ16-25A

Models	E	F	G
EWA/YQ16BAWN	736	619	371
EWA/YQ21BAWN	768	613	372
EWA/YQ25BAWN	768	613	372
EWA/YQ16BAWP	711	602	379
EWA/YQ21BAWP	745	599	379
EWA/YQ25BAWP	745	599	379

Legend:

 Required space around the unit for service and air intake

 Centre of gravity

NOTES

	1	2
A	300	500
B	100	500
C	500	500
D	500	500

1= Distance from wall (or other unit) for regions without heavy snowfall.
2= Distance from wall (or other unit) for regions with heavy snowfall.

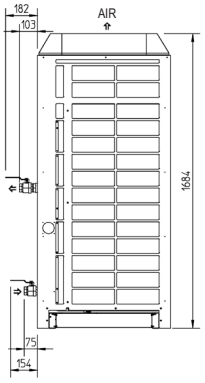
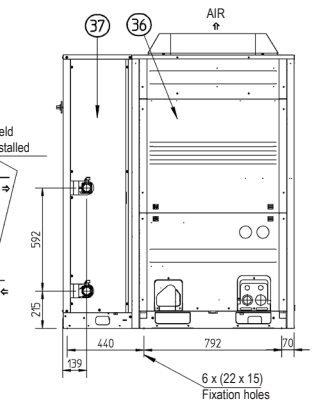
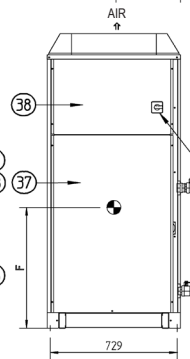
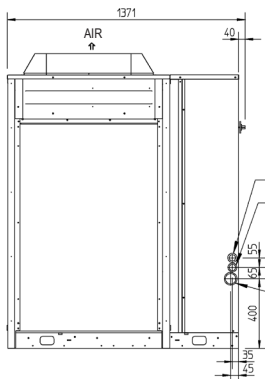
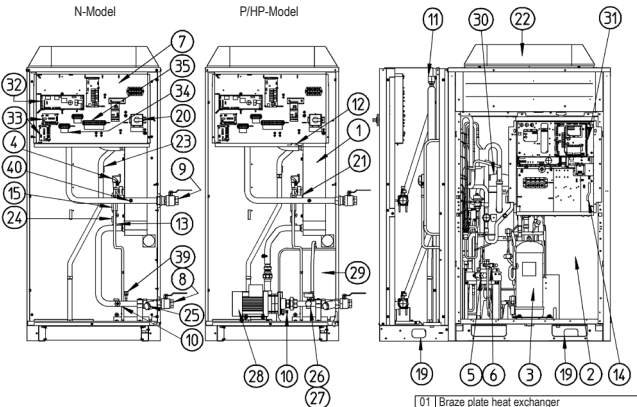
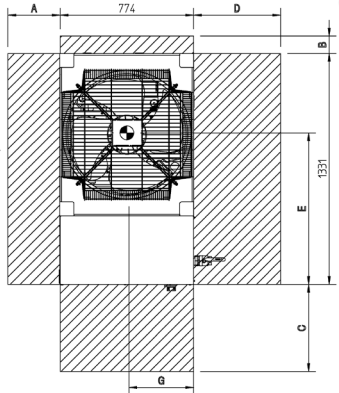

- 01 Braze plate heat exchanger
- 02 Coil
- 03 Compressor
- 04 Expansion valve
- 05 Gas stopvalve
- 06 Liquid stopvalve
- 07 Switchbox hydromodule
- 08 Chilled water IN (G1-1/4 female shutoff valve)
- 09 Chilled water OUT (G1-1/4 female shutoff valve)
- 10 Water drain
- 11 Air purge
- 12 Leaving water temperature sensor
- 13 Entering water temperature sensor
- 14 Ambient temperature sensor
- 15 Refrigerant filter
- 16 Power supply intake (Ø45)
- 17 Low voltage supply intake (Ø29)
- 18 High voltage supply intake (Ø29)
- 19 Lifting eye for sling
- 20 Main isolator switch
- 21 Flowswitch
- 22 Fan
- 23 Gas pipe sensor
- 24 Liquid pipe sensor
- 25 Water filter
- 26 Water safety valve (Optional)
- 27 Water pressure gauge (Optional)
- 28 Pump (Optional)
- 29 Expansion vessel (Optional)
- 30 Accumulator (Optional)
- 31 Switchbox outdoor module
- 32 Main pcb hydro module
- 33 Demand pcb (Optional)
- 34 Low voltage terminal
- 35 High voltage terminal
- 36 Service panel outdoor module
- 37 Service panel hydro module
- 38 Service panel switchbox hydromodule
- 39 Water pressure port before brazed plate heat exchanger
- 40 Water pressure port after brazed plate heat exchanger